

Dimensions	Great Barn		Small Barn	Whole Suite	Board Room 1	Board Room 2	Whole Centre
	Main Room	Extension					
Length Feet	101	20	54	155	23	23	-
Metres	30.6	6	16.3	47.1	7.1	7.1	-
Width feet	22	24	24	22	23	23	-
Metres	6.7	7.5	7.4	6.7	7.1	7.1	-
Area Sq. feet	2222	480	1296	3518	529	529	1292
Area Sq. metres	206	45	120	326	50.5	50.5	123

### Knights Barn Ground Floor

### Great Barn

### Small Barn

Capacities	Great Barn		Small Barn	Whole Suite	Board Room 1	Board Room 2
	Main Room	Extension				
Theatre Style	190		90	-		
Classroom	120		50	-		
Board Room	-		30	-		
Buffet/Reception	200		60	250		
Dinner/Dance	156		40	216		
Dinner	228		60	288		
U-Shaped	40		30	-	16	16
Cabaret	72		30	-		

- Key to Plans**
- Microphone socket
  - 13 amp socket
  - WW Folding or removable partition
  - 60 amp Three Phase Power available in Great and Small Barns
  - ★ Broadband point
  - ☎ Telephone point
  - ◻ Door
  - CC climate control

# ROOM DIAGRAMS

All dimensions shown in feet

## Captains Room

Ground Floor

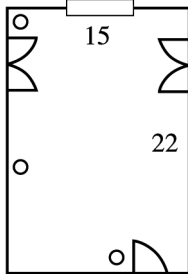

## Admirals Room

Ground Floor

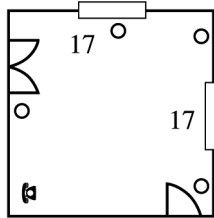

## Library

Ground Floor

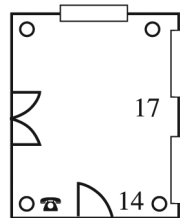

## Study

Ground Floor

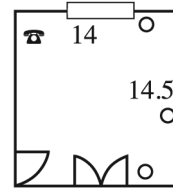

Captains Room

Admirals Room

Library

Study

### Dimensions

Length Feet	22	17	14	14
Metres	6.7	5.25	4.25	4.25
Width feet	15	17	17	14.5
Metres	4.5	5.25	5.25	4.5
Area Sq. feet	330	289	238	203
Area Sq. metres	30	27.5	22	19

### Capacities

Theatre Style	-	16	-	-
Classroom	-	-	-	-
Board Room	14	12	-	-
Buffet/Reception	-	-	-	-
Dinner/Dance	-	-	-	-
Dinner	20	16	-	-
Informal meeting	-	-	10	6
U-Shaped	-	-	-	-
Cabaret	-	-	-	-

### Key to Plans

- 13 amp socket
- ☎ Telephone point
- ◻ Door

